

City of Newark
2012 Average Daily Traffic Data

No.	Street	1/02 Average Daily Traffic			5/12 Average Daily Traffic			% Change From 2002
		NB/WB	SB/EB	TOTAL	NB/WB	SB/EB	TOTAL	
Balentine Drive								
1	Stevenson Boulevard to Mowry School Road	9,120	7,370	16,490	6,174	6,559	12,733	-23%
2	Mowry School Road to NewPark Entrance	6,120	7,560	13,680	4,799	4,756	9,555	-30%
3	NewPark Entrance to Cedar Boulevard	1,420	1,260	2,680	825	700	1,525	-43%
Bettencourt Street								
4	Mayhews Landing Road to Haley Street	2,020	820	2,840	964	983	1,947	-31%
Birch Street								
5	Cedar Boulevard to Smith Avenue	1,480	1,140	2,620	1,173	1,016	2,189	-16%
6	Robertson Avenue to Cental Avenue	640	530	1,170	657	717	1,374	17%
Carter Avenue/Filbert Street								
7	Sycamore Street to Enterprise Drive	1,920	1,910	3,830	1,746	1,772	3,518	-8%
8	Enterprise Drive to Central Avenue	1,840	1,820	3,660	1,781	1,820	3,601	-2%
Cedar Boulevard								
9	Thornton Avenue to Haley Street			-	365	380	745	
10	Haley Street to Lido Boulevard	1,900	1,540	3,440	1,626	1,599	3,225	-6%
11	Lido Boulevard to Newark Boulevard	3,970	3,160	7,130	3,735	3,666	7,401	4%
12	Newark Boulevard to Lake Boulevard	7,310	7,170	14,480	5,495	6,309	11,804	-18%
13	Lake Boulevard to Musick Avenue	10,790	9,740	20,530	9,667	9,422	19,089	-7%
14	Musick Avenue to Thornton Avenue	12,460	11,490	23,950	10,970	10,711	21,681	-9%
15	Thornton Avenue to Civic Terrace Avenue	8,920	9,000	17,920	7,667	8,246	15,913	-11%
16	Civic Terrace Avenue to Central Avenue	8,500	8,650	17,150	6,693	7,335	14,028	-18%
17	Central Avenue to Moores Avenue	7,230	7,120	14,350	6,437	6,265	12,702	-11%
18	Moores Avenue to Birch Street	7,180	7,010	14,190	5,754	5,389	11,143	-21%
19	Birch Street to Mowry Avenue	7,630	8,250	15,880	6,921	7,303	14,224	-10%
20	Mowry Avenue to North NewPark Entrance	9,100	9,430	18,530	7,643	8,231	15,874	-14%
21	N. New Park Entrance to S. New Park Entra	9,950	8,350	18,300	6,802	7,047	13,849	-24%
22	South NewPark Entrance to Balentine Drive	7,600	6,110	13,710	5,090	5,231	10,321	-25%
23	Balentine Drive to Stevenson Boulevard	6,850	7,040	13,890	4,406	5,356	9,762	-30%
Central Avenue								
24	I-880 Freeway to Cedar Boulevard	6,460	7,850	14,310	5,802	7,096	12,898	-10%
25	Cedar Boulevard to Newark Boulevard	4,360	5,520	9,880	3,836	4,841	8,677	-12%
26	Newark Boulevard to Cherry Street	6,150	6,510	12,660	5,596	6,059	11,655	-8%
27	Cherry Street to Filbert Street	9,240	8,550	17,790	7,059	8,398	15,457	-13%
28	Filbert Street to Willow Street	6,570	7,350	13,920	3,046	3,788	6,834	-51%
Cherry Street								
29	Newark Boulevard to Mayhews Landing Road	1,800	1,880	3,680	1,460	1,248	2,708	-26%
30	Mayhews Landing Road to Thornton Avenue	2,310	2,080	4,390	2,745	2,816	5,561	27%
31	Thornton Avenue to Central Avenue	5,300	5,920	11,220	5,360	5,053	10,413	-7%
32	Central Avenue to Moores Avenue	12,210	13,130	25,340	12,423	13,106	25,529	1%
33	Moores Avenue to Mowry Avenue	12,320	13,150	25,470	12,229	13,067	25,296	-1%
34	Mowry Avenue to Joaquin Murieta Avenue	8,010	9,480	17,490	8,740	9,608	18,348	5%
35	Joaquin Murieta Avenue to Stevenson Bld.	7,500	8,800	16,300	6,865	8,295	15,160	-7%
Edgewater Drive								
36	Lake Boulevard to Croydon Place	1,760	1,720	3,480	1,259	1,311	2,570	-26%
37	Croydon Place to Cedar Boulevard	1,350	1,380	2,730	2,672	2,110	4,782	75%
Enterprise Drive								
38	Filbert Street to Wells Avenue	1,140	1,140	2,280	571	636	1,207	-47%
39	Wells Avenue to Willow Street	770	760	1,530	702	737	1,439	-6%
Fircrest Street								
40	Jarvis Avenue to Gateway Boulevard	2,820	3,520	6,340	1,032	1,019	2,051	-68%
Gateway Boulevard								
41	Fircrest Street to Jarvis Avenue	1,320	1,010	2,330	395	380	775	-67%
42	Jarvis Avenue to Thornton Avenue	6,130	5,070	11,200	3,714	3,957	7,671	-32%
Haley Street/Sycamore Street								
43	Jarvis Avenue to Cedar Boulevard	2,060	2,060	4,120	2,997	3,128	6,125	49%
44	Cedar Boulevard to Mayhews Landing Road	2,500	2,720	5,220	2,388	2,648	5,036	-4%
45	Mayhews Landing Road to Thornton Avenue	3,020	2,840	5,860	2,530	2,809	5,339	-9%
46	Thornton Avenue to Central Avenue	3,030	3,110	6,140	2,149	2,670	4,819	-22%

No.	Street	1/02 Average Daily Traffic			5/12 Average Daily Traffic			% Change From 2002
		NB/WB	SB/EB	TOTAL	NB/WB	SB/EB	TOTAL	
Jarvis Avenue								
47	Lake Boulevard to Newark Boulevard	4,200	3,750	7,950	3,624	3,301	6,925	-13%
48	Newark Boulevard to Lido Boulevard	10,930	10,520	21,450	7,066	8,129	15,195	-29%
49	Lido Boulevard to Haley Street	10,220	9,200	19,420	5,185	5,193	10,378	-47%
50	Haley Street to Gateway Boulevard	3,870	3,440	7,310	2,346	2,453	4,799	-34%
Joaquin Murieta Avenue								
51	Cedar Boulevard to Cherry Street	1,270	1,270	2,540	1,703	2,026	3,729	47%
Lake Boulevard								
52	Jarvis Avenue to Edgewater Drive	3,300	3,200	6,500	2,780	2,915	5,695	-12%
53	Edgewater Drive to Cedar Boulevard	2,180	2,100	4,280	1,791	1,837	3,628	-15%
Mayhews Landing Road								
54	Thornton Avenue to Newark Boulevard	1,940	1,620	3,560	1,732	2,308	4,040	13%
55	Newark Blvd to Haley Street/Sycamore Stre	1,880	1,980	3,860	1,593	1,563	3,156	-18%
56	Sycamore Street to Spruce Street	2,020	2,120	4,140	2,256	2,247	4,503	9%
57	Spruce Street to Willow Street	420	410	830	354	238	592	-29%
Mowry Avenue								
58	I-880 Freeway to NewPark Entrance	23,620	16,520	40,140	15,352	18,560	33,912	-16%
59	NewPark Entrance to Cedar Boulevard	13,140	14,770	27,910	12,274	12,377	24,651	-12%
60	Cedar Boulevard to Cherry Street	8,880	7,890	16,770	7,658	7,256	14,914	-11%
61	Cherry Street to Railroad Tracks	1,540	1,440	2,980	494	460	954	-68%
Mowry School Road								
62	Balentine Drive to Cedar Boulevard	890	930	1,820	481	674	1,155	-37%
Newark Boulevard								
63	SR-84 Freeway to Jarvis Avenue	21,490	22,680	44,170	19,751	20,009	39,760	-10%
64	Jarvis Avenue to Cedar Boulevard	11,150	11,010	22,160	10,259	10,440	20,699	-7%
65	Cedar Boulevard to Lafayette Avenue	7,160	7,600	14,760	6,053	7,341	13,394	-9%
66	Lafayette Avenue to Thornton Avenue	6,690	7,510	14,200	6,034	6,637	12,671	-11%
67	Thornton Avenue to Central Avenue	5,940	5,440	11,380	5,775	5,613	11,388	0%
Robertson Avenue								
68	Cedar Boulevard to Birch Street	720	700	1,420	660	709	1,369	-4%
69	Birch Street to Cherry Street	860	540	1,400	565	558	1,123	-20%
Smith Avenue								
70	Cedar Boulevard to Birch Street	730	650	1,380	694	655	1,349	-2%
71	Birch Street to Cherry Street	1,140	1,030	2,170	950	1,316	2,266	4%
Spruce Street								
72	Thornton Avenue to Mayhews Landing Road	1,220	1,160	2,380	1,148	1,100	2,248	-6%
73	Mayhews Landing Road to Bridgepointe Driv	850	1,040	1,890	629	694	1,323	-30%
74	Bridgepointe Drive to Jarvis Avenue	1,230	1,310	2,540	797	836	1,633	-36%
Stevenson Boulevard								
75	I-880 Freeway to Balentine Drive	19,730	17,420	37,150	13,723	13,461	27,184	-27%
76	Balentine Drive to Cedar Boulevard	11,410	12,030	23,440	10,611	11,367	21,978	-6%
77	Cedar Boulevard to Cherry Street	7,140	7,280	14,420	7,473	7,468	14,941	4%
78	Cherry Street to Railroad Tracks	1,990	1,460	3,450	2,817	2,791	5,608	63%
Thornton Avenue								
79	I-880 Freeway to Cedar Boulevard	22,850	21,250	44,100	20,966	21,316	42,282	-4%
80	Cedar Boulevard to Newark Boulevard	12,800	13,080	25,880	9,610	10,629	20,239	-22%
81	Newark Boulevard to Cherry Street	10,980	9,710	20,690	8,942	9,710	18,652	-10%
82	Cherry Street to Sycamore Street	8,560	8,740	17,300	7,654	8,165	15,819	-9%
83	Sycamore Street to Willow Street	4,390	4,840	9,230	5,725	6,868	12,593	36%
84	Willow Street to Gateway Boulevard	8,040	7,320	15,360	5,134	6,625	11,759	-23%
85	Gateway Boulevard to SR-84 Freeway	11,410	10,840	22,250	8,094	9,529	17,623	-21%
Wells Avenue								
86	Filbert Street to Enterprise Drive	850	930	1,780	1,225	1,195	2,420	36%
Willow Street								
87	Central Avenue to Enterprise Drive	3,670	3,450	7,120	2,267	2,910	5,177	-27%
88	Enterprise Drive to Thornton Avenue	4,150	4,300	8,450	2,812	3,524	6,336	-25%
89	Thornton Avenue to Cedar Boulevard	840	760	1,600	857	749	1,606	0%

City of Newark - Engineering and Traffic Survey
 Roadway Segment Map and Average Daily Traffic (Directional)
 Figure 1

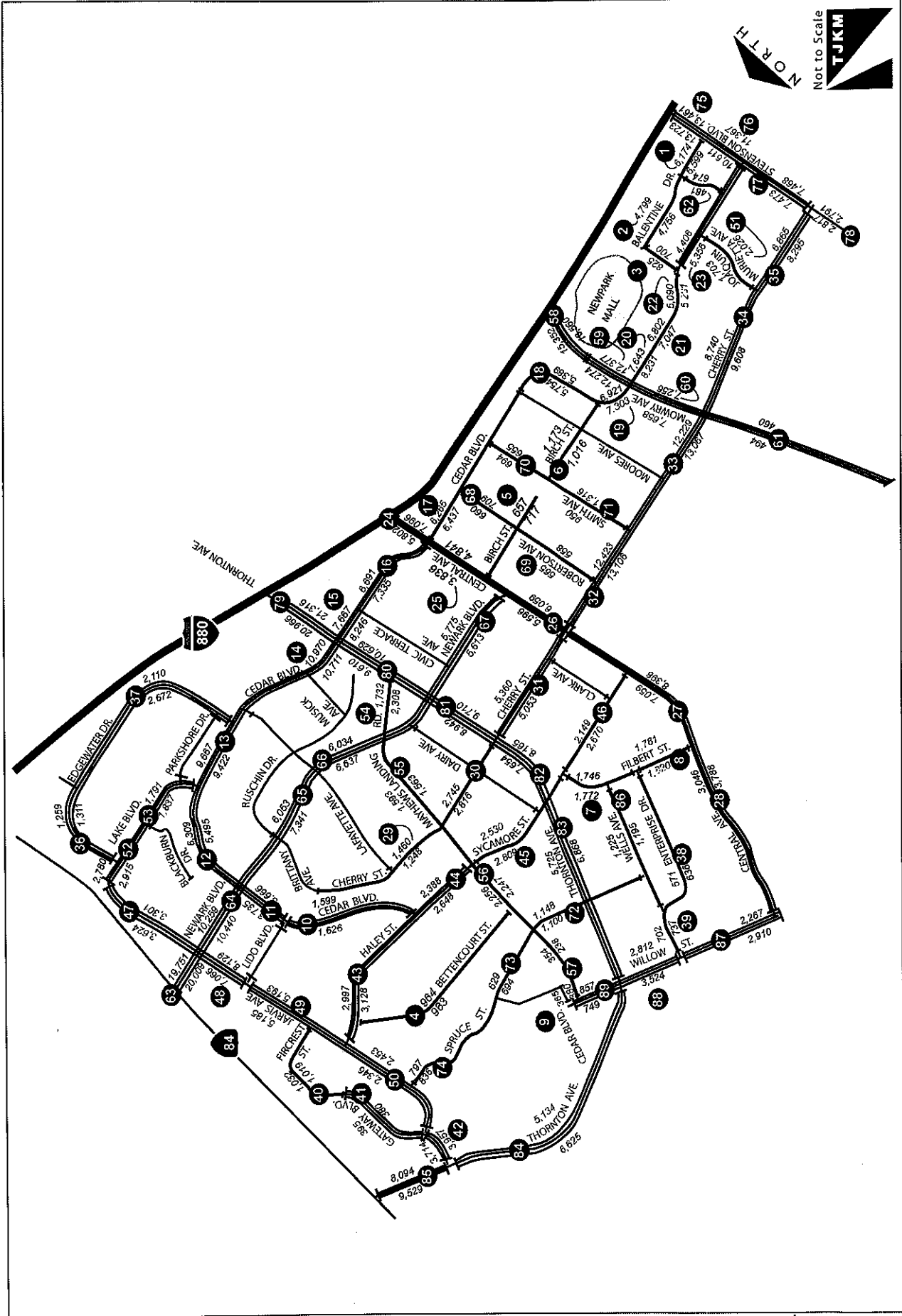

City of Newark - Engineering and Traffic Survey
 Roadway Segment Map and Average Daily Traffic (Total)

Figure
 2

